

HEALTH PRO WB13 SLOW JUICER

BOROSIL[®]

Performs Beautifully



USER MANUAL

BSJU20WB13

READ ALL INSTRUCTIONS BEFORE USING THIS APPLIANCE

INTRODUCTION

Congratulation on your purchase of
BOROSIL HEALTH PRO WB13 SLOW JUICER!

IMPORTANT SAFEGUARDS

When using electrical appliances, basic safety precautions should always be followed including the following:

- Use only 230V, 50Hz AC power supply.
- Do not operate the appliance if it has malfunctioned or has been damaged in any manner. Never try to repair the product by yourself. Contact our Customer Care Toll free no. **1800 2106 520/1800 224 552** or e-mail us at **myborosil@borosil.com** for examination and repair.
- The product is applicable for household and not for commercial purpose.
- Do not let power cord hang over the edge of the table or counter, or touch hot surfaces.
- This appliance is not intended for usage by persons (including children) with reduced physical, sensory or mental capabilities, or lack of experience and knowledge, unless under supervision or given instructions concerning the usage of the appliance by a person responsible for their safety. Children should be supervised to ensure that they do not play with the appliance.
- Before using, place the appliance on an even, stable surface; operate according to the instructions given.
- Before dismantling or installing any part of the product, disconnect the power supply.
- To prevent accident, do not immerse the machine into water. You may scrub with soft cloth.
- Keep fingers or hard objects out of feeder tube during operation. The contact with the squeezing gear would cause injury or product may get damaged.
- Use the original product provided by manufacturer. Never use other objects instead of the material pusher. To prevent accidents, keep eyes out of the feeder tube.
- After juicing, turn switch to "STOP" and do not dismantle product accessory until the motor is completely stopped.
- Do not operate the product without being watched.
- To prevent product damage during use, do not add hard object (such as nuts), fiber-rich foods (such as sugar cane), less-juice foods (such as banana) and non-food object from feeder tube. To prevent injury and damage, use pusher instead of hand if foods are stuck at the feeder tube
- Store the product at a dry place away from direct sunlight.

DESCRIPTION OF PRODUCT

Part Description:

- 1) Pusher
- 2) Feeder Tube
- 3) Squeezing Gear/ Juicer Gear
- 4) Juice Filter
- 5) Screen Brush
- 6) Juice & Pulp Separator
- 7) Juice Extracting Mouth
- 8) Motor Unit
- 9) Juicer Jug
- 10) Pulp Collector Jug
- 11) Cleaning Brush

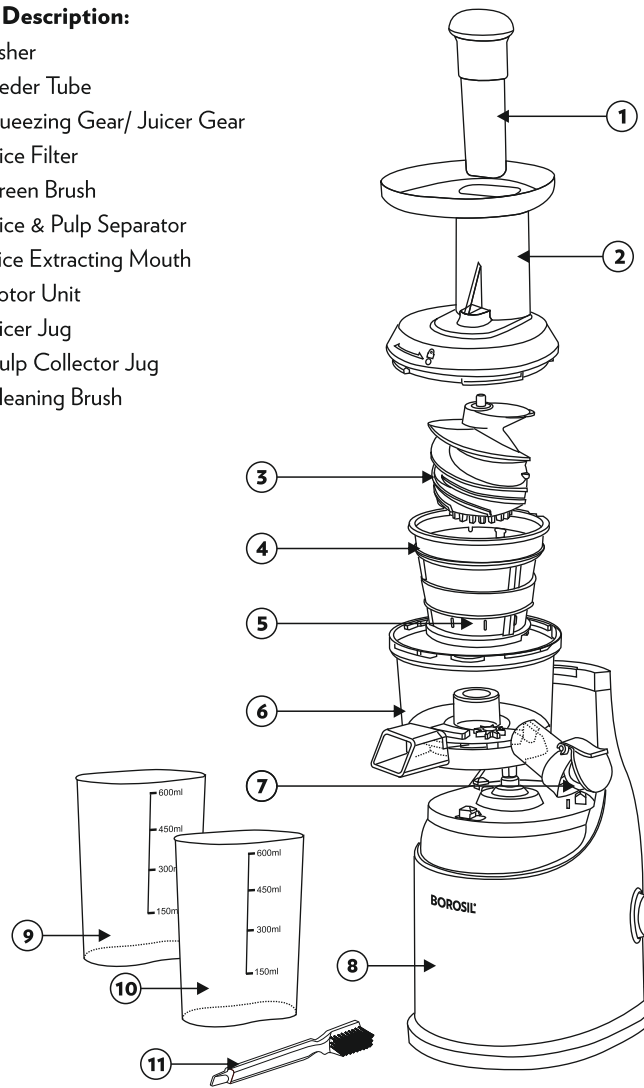

TECHNICAL DATA:

Specifications : 200 W, 230V~50Hz

HOW TO USE

BEFORE USING

- Read all instructions carefully and keep them for future reference.
- Dismantle package and place all parts on a flat table.
- Before startup, take out all accessories, reinstall the machine before trial operation.
- Immerse all removable parts and accessories in warm water and dry them. To prevent electric shock and machine damage, do not immerse the main machine in water.
- Before assembly, be sure no power lines are inserted and the switch is at "STOP" position.
- Use only the accessories recommended by the manufacturer.
- After each use, turn off switch and before dismantling parts, be sure the motor has stopped rotating, pull out power lines.

Remark: Before use, assemble all parts as per drawing, otherwise the normal operation would be affected.

Detailed operation procedures:

1. Take out feeder tube and align it with the positioning direction of machine (See Figure 1);
2. Take out juice filter and keep it into screen cylinder (See Figure 2);
3. Align juice filter with feeder tube (See Figure 3);
4. Take out squeezing gear to align it with motor shaft (See Figure 4).
5. Take out pusher and insert it into surface cover (See Figure 5);
6. Keep the unlocking mark on surface cover in alignment with the triangle mark on the feeder tube (See Figure 6);
7. Rotate clockwise for tightening and anticlockwise for loosening (See Figure 7);
8. Optional juice-extracting mouth assembly (See Figure 8)

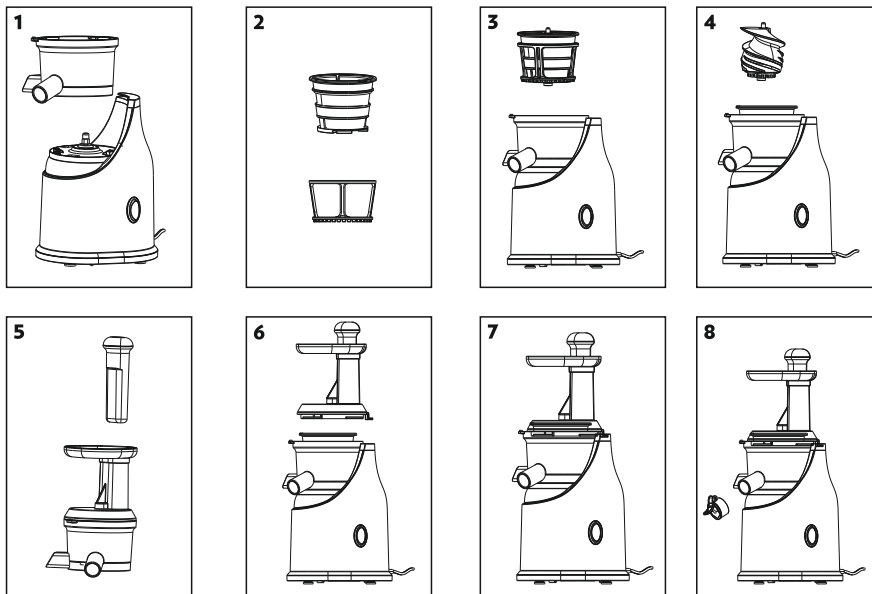

JUICING

1. Ensure all accessories are correctly installed and the juice collector and pulp collector are properly placed.
2. Put the power plug into the main socket and switch ON the main supply.
3. In order to insert fruits in the feeder tube easily, cut fruits into pieces.
4. To start the juicing process select the switch from "O" to "ON" position; the juicer will start operating.
5. Put the fruit pieces into the feeder tube and slowly push it down with the pusher, in order to avoid the fruit pieces from getting stuck in the feeder tube.
6. Make sure the juice outlet cap is in open position in order to collect the juice into the juice jug and ensure that the pulp is getting collected into the pulp collector.
7. To clean the filter / to remove the stuck pulp shift the switch to "R" position. The motor will rotate in reverse direction and the stuck pulp will get resolved.

Note:

- a) Fruits with less juice such as banana, apricot, etc. are not recommended to be used in the Slow Juicer.
- b) To prevent product damage during use, do not add hard objects or hard food material like sugarcane, nuts, the core of pineapple, raw fruits like unpeeled lemon.
- c) Make sure the Slow Juicer does not run continuously for more than 15 minutes.

CLEANING AND MAINTENANCE

1. Before cleaning, unplug the power plug from the main socket and let the machine stop completely.
2. Remove all the parts in a reverse procedure.
3. Clean all the accessories with water except the motor unit
4. After juicing, remove all parts as per the reverse procedure;
5. After cleaning, dry the product with a dry cloth, install and store it in a dry and safe place.
6. Before flushing the outlet of feeder tube, pull out the bottom silicon sheet and, after cleaning, install silicon sheet correctly;

Warning: To prevent scratches, take care and properly clean the mesh of strainer.

ENVIRONMENT FRIENDLY DISPOSAL



You can help protect the environment!

Please remember to respect the local regulations:

Hand in the non-working electrical equipment to an appropriate waste disposal center.

TROUBLESHOOTING

Problem	Solution
Fail to operate	Check power plugs and ensure that the Slow Juicer is correctly assembled.
Juicing failure / no dry pulp	Be sure the rubber sheet at the bottom of the feeder tube is tightened. See the assembly method for rubber sheet. Check if fresh materials are selected; Materials that have been stored in refrigerator for a long time should be defrosted in clean water before use.
Operation stops in between	Check if too much food stuff is inserted in the Slow Juicer Check if the fruit is not pitted. Press down "0" under standby state for 3-5 sec, then press down "R" 3-5 sec to reversely operate the product, and press down ON. If squeezing gear does not work, stop using the product, dismantle the parts of feeder tube and, clean the parts before use.
Abnormal noise during juicing	Check the following: Slow Juicer is running with no food material inserted. Hard food material inserted. Accessories are not properly installed.
Unpleasant smell is emitted	This is a normal phenomenon when using the appliance for the first time, the smell will disappear after the appliance works for a while.

WARRANTY FOR REPAIR & SERVICES

This product comes with a warranty of Two Years on product from the date of purchase as specified on the Warranty Card. This is against all defective material or workmanship. In the event of a defect, Borosil Limited at its sole choice, will either repair or replace this product or any component of the product found to be defective free of cost through the dealer from whom it has been purchased or at any of the Borosil Authorized Service Centre or at Customer place during the warranty period.

For any information or problem, contact Borosil Customer Care Toll free no. **1800 2106 520/1800 224 552** or e-mail us at **myborosil@borosil.com** or contact your local dealer or Borosil Authorized Service Centre and provide information about the defect with the model number and the serial number of the product.

The warranty is not valid in case:

1. Product is not used according to user manual.
2. Defects caused by improper or reckless use.
3. Repairs done by persons other than Borosil Authorized Service Centre.
4. Modifications of any nature made in the product.
5. Tampered serial number and incomplete warranty card after purchase.
6. Product if used for commercial purpose (i.e. other than domestic use).
7. Usage of parts not recommended by Borosil or those made by other manufacturers.
8. The model no. on the invoice is different from the product to be repaired.
9. Borosil is not responsible for accidents arising due to the use of accessories not designed for the utilisation with this product.
10. If the defects are caused by fire, flood and the other act of god.
11. If the defects are caused by use of incorrect current or voltage or faulty electric power supply.
12. All consumables and parts susceptible to normal wear & tear are not covered under warranty.
13. This warranty does not cover damage or injury caused by accident, mishandling, misuse or normal wear and tear or for loss of injury, directly or indirectly arising out of use of this product. The decision of the company in this regard shall be final.
14. If the product is used with any type of adapter or connector.
15. If the product is used in locations with different electrical specifications.

WARRANTY CARD	BOROSIL®
THIS CARD IS VALID ONLY IF IT IS FILLED IN COMPLETELY, SIGNED AND STAMPED BY THE DEALER ON THE DATE OF PURCHASE	
MODEL CODE :	BSJU20WB13
CUSTOMER'S NAME :	_____
ADDRESS :	_____
PHONE NO. RESIDENCE :	_____ OFFICE : _____
DATE OF PURCHASE & BILL NO. :	_____
DEALER NAME & SIGN :	_____
CUSTOMER'S SIGNATURE :	_____
DEALER'S STAMP	

BOROSIL®

CORPORATE OFFICE :

BOROSIL LIMITED

1101, Crescenzo, G-Block, BKC, Bandra (East), Mumbai - 400 051, Maharashtra.
Website: www.borosil.com | Customer Care Toll Free No.: 1800 2106 520/1800 224 552
Email id: myborosil@borosil.com | Tel.: 022 6740 6300 | Fax: 022 6740 6514
CIN NO.: L36100MH2010PLC292722

SALES OFFICE :

MUMBAI:

Kanakia Zillion, B-Wing, Unit No. 306, L.B.S. Marg, Next to Kurla Bus Depot,
Kurla (W), Mumbai - 400 070.
Tel.: 022 6740 6400 | Fax: 022 6740 6444
email: mumbaisales@borosil.com

DELHI:

19/90, P-Block, Connaught Place (Madras Hotel Block), New Delhi -110 001.
Tel.: 011 2334 3897 / 2374 2136 | Fax: 011 2374 6689
email: delhi@borosil.com

CHENNAI:

New No. 20, (Old No. 9) 1st Floor, Brahadammal Road, Nungambakkam, Chennai - 600 034.
Tel.: 044 2822 6012 / 2822 6013 | Fax: 044 2822 6014
email: borosilmso@ethnet / chennai@borosil.com

KOLKATA:

E-2/3, 2nd Floor, Gillander House, Netaji Subhash Road, Kolkata, West Bengal - 700 001.
Tel.: (033) 2229-9166, 2226-2045
email: calcutta@borosil.com

GURUGRAM:

201, 2nd Floor, CRS Towers, Plot No. 77-B, Village Sarhaul, Iffco Road, Sector-18,
Gurugram, Haryana - 122 015. Tel.: +91 124 6926 318



GOT A SERVICE-RELATED QUERY OR
NEED CUSTOMER SUPPORT?



SCAN THE QR CODE &
PLACE YOUR
SERVICE REQUEST
ON WHATSAPP 24 x 7
+91 7208487334



Now shop India's most trusted brand online at www.myborosil.com

Follow us on    Borosil And You

Back Cover - Close Size - 140 x 215 mm